

FLEXIBLE SPACES, COLLABORATIVE AREAS, FUTURE GROWTH, AND ROOM FOR CONNECTION... WE CAN'T WAIT TO SEE THIS COME TO LIFE.

## FIRST FLOOR

### Welcoming & Family-Friendly Spaces

- Spacious new lobby and reception/waiting area
- Secure preschool check-in area
- Coffee shop connection space
- Comfortable nursing mothers room

### Preschool & Kids Areas

- Four dedicated preschool classrooms
  - Convenient in-room restroom access
  - Flexible classroom partition options
- Designed for safe, engaging learning environments

### Staff & Ministry Areas

- Dedicated offices for pastors and admin staff
- Conference room and collaborative workspaces
- Break area for staff connection and support
- Study and counseling spaces

### Functional & Intentional Design

- Improved circulation and hallway flow
- Multiple storage and utility spaces
- Centralized collaboration areas

Thoughtfully designed for ministry and community use



EXPANSION AHEAD

# GRACELIFE BUILDING PROJECT

[GRACELIFEFAMILY.ORG/BUILDINGPROJECT](http://GRACELIFEFAMILY.ORG/BUILDINGPROJECT)

## SECOND FLOOR

### Future Growth Opportunities

- Nearly 8,000 SF designated for future use
- Flexible layout ready for expansion
- Large common area for gathering and events

### Expanded Learning Space

- Additional classroom expansion area
- Existing classrooms integrated into overall design
- Open-concept possibilities for future programming

### Multi-Purpose Functionality

- Space adaptable for events or ministry needs
  - Designed with long-term growth in mind
- Encourages collaboration and community connection

OFFICE & PRESCHOOL ACCESS

## EXTERIOR AND BACK OF BUILDING

 GraceLife

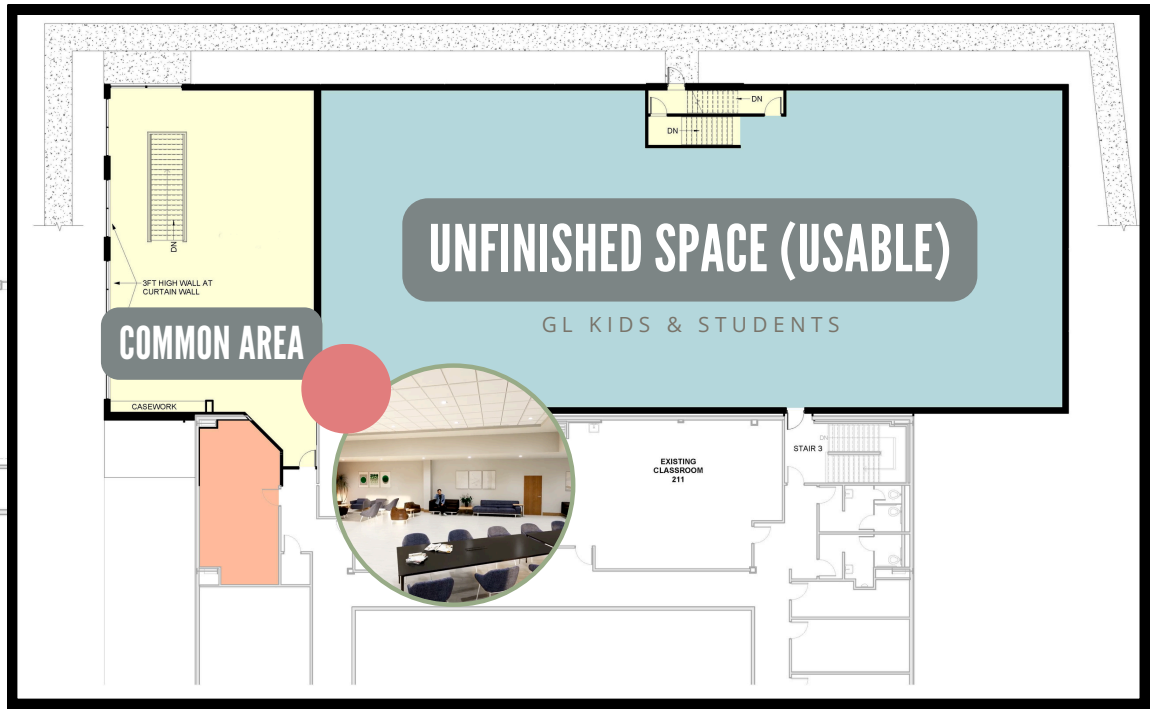

UPPER LEVEL

# THE VISION

The design was created to facilitate the Lord's continued work through growing families, increased attendance and NextGen needs. The space will include welcoming common areas, secure preschool rooms, functional and collaborative staff spaces, current and future expansion for children and students, and a dedicated coffee center. Every part of this new addition will be flexible, functional, and keep our long-term vision in place.